

Tokyo 2020 Olympic Games

Venue Guide



July 23 – August 8, 2021

VENUE MAP

HERITAGE ZONE

TOKYO BAY ZONE

OV
PV

Tokyo International Airport (Haneda Airport)

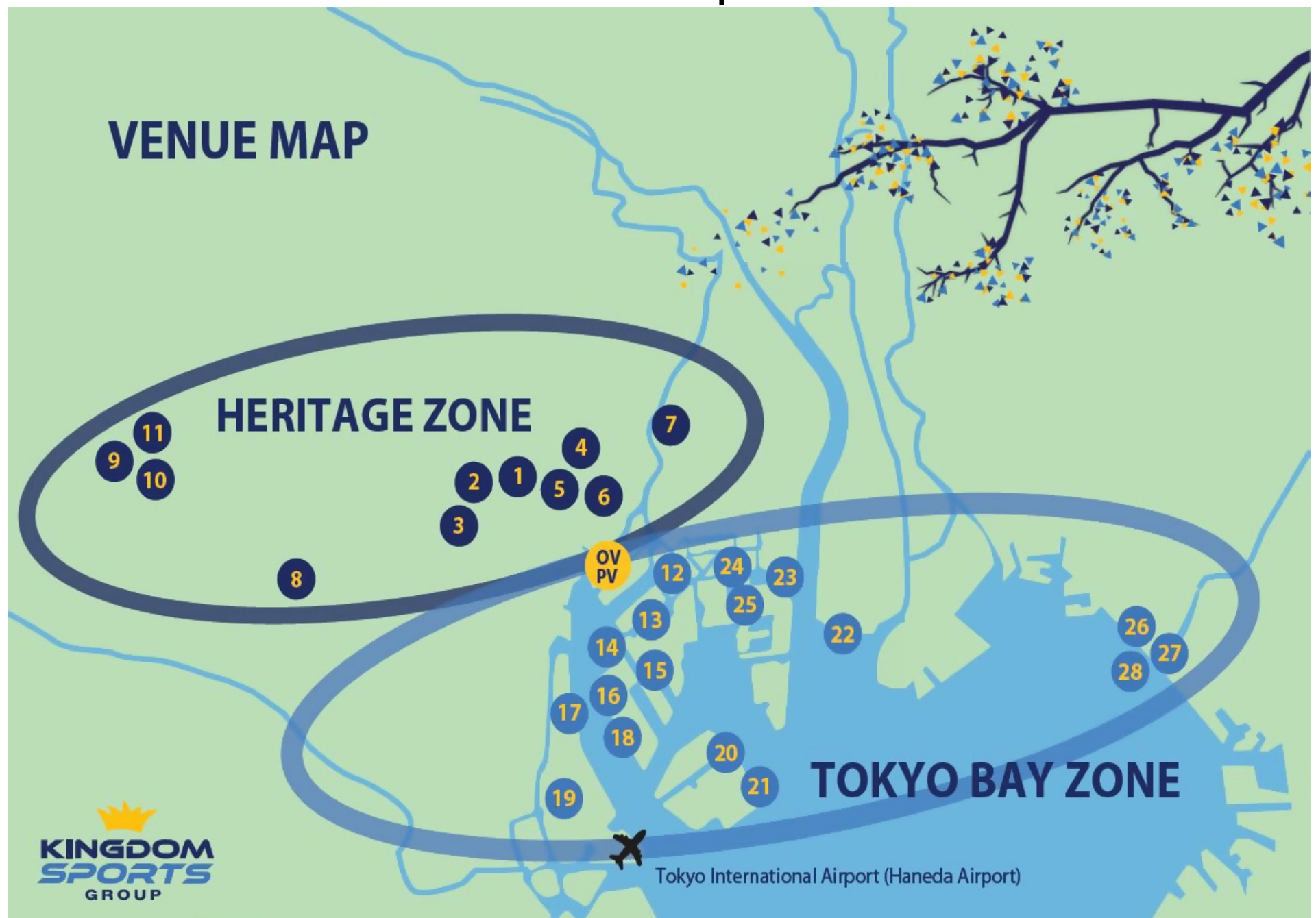

Zone	Sports	Venue	Number
Heritage Zone	Opening and Closing Ceremony, Athletics, Football	Olympic Stadium	1
Heritage Zone	Table Tennis	Tokyo Metropolitan Gymnasium	2
Heritage Zone	Handball,	Yoyogi National Stadium	3
Heritage Zone	Judo, Karate	Nippon Budokan	4
Heritage Zone	Athletics (Race Walk)	Imperial Palace Garden	5
Heritage Zone	Weightlifting	Tokyo International Forum	6
Heritage Zone	Boxing	Kokugikan Arena	7
Heritage Zone	Equestrian (Dressage, Eventing, Jumping),	Equestrian Park	8
Heritage Zone	Badminton, Modern Pentathlon (Fencing)	Musashino Forest Sports Plaza	9
Heritage Zone	Football, Rugby, Modern Pentathlon (Swimming, Fencing, Riding, Laser-run)	Tokyo Stadium	10
Heritage Zone	Cycling (Road)	Musashinonomori Park	11

For detailed information on each venue please download our venue specific brochure



Tokyo Bay Zone

Zone	Sports	Venue	Number
Tokyo Bay Zone	Volleyball (Volleyball)	Ariake Arena	12
Tokyo Bay Zone	Gymnastics	Ariake Gymnastics Centre	13
Tokyo Bay Zone	Cycling (BMX Freestyle, BMX Racing), Skateboarding	Ariake Urban Sports Centre	14
Tokyo Bay Zone	Tennis	Ariake Tennis Park	15
Tokyo Bay Zone	Triathlon, Aquatics (Marathon Swimming)	Odaiba Marine Park	16
Tokyo Bay Zone	Volleyball (Beach Volleyball)	Shiokaze Park	17
Tokyo Bay Zone	Basketball (3X3), Sports Climbing	Aomi Urban Sports Park	18
Tokyo Bay Zone	Hockey	Oi Hockey Stadium	19
Tokyo Bay Zone	Equestrian (Eventing Cross Country)	Sea Forest Cross-Country Course	20
Tokyo Bay Zone	Rowing, Canoe (Sprint)	Sea Forest Waterway	21
Tokyo Bay Zone	Canoe (Slalom)	Kasai Canoe Slalom	22
Tokyo Bay Zone	Archery	Yumenoshima Park Archery Field	23
Tokyo Bay Zone	Aquatics (Swimming, Diving, Artistic Swimming)	Tokyo Aquatic Centre	24
Tokyo Bay Zone	Aquatics (Water Polo)	Tatsumi Water Polo Centre	25
Tokyo Bay Zone	Taekwondo, Wrestling	Makuhari Messe Hall A	26
Tokyo Bay Zone	Fencing	Makuhari Messe Hall B	27
Tokyo Bay Zone	Paralympic	Makuhari Messe Hall C	28

For detailed information on each venue please download our venue specific brochure



Other Venues

Zone	Sport	Venue	Number
Other Venues	Surfing	Tsurigasaki Surfing Beach	29
Other Venues	Basketball (Basketball)	Saitama Super Arena	30
Other Venues	Shooting	Asaka Shooting Range	31
Other Venues	Golf	Kasumigaseki Country Club	32
Other Venues	Sailing	Enoshima Yacht Harbour	33
Other Venues	Cycling (Track)	Izu Velodrome	34
Other Venues	Cycling (Mountain Bike)	Izu MTB Course	35
Other Venues	Cycling (Road)	Fuji International Speedway	36
Other Venues	Baseball/Softball	Fukushima Azuma Baseball Stadium	37
Other Venues	Baseball/Softball	Yokohama Baseball Stadium	38
Other Venues	Football	Sapporo Drome	39
Other Venues	Football	Miyagi Stadium	40
Other Venues	Football	Ibaraki Kashima Stadium	41
Other Venues	Football	Saitama Stadium	42
Other Venues	Football	International Stadium Yokohama	43

For detailed information on each venue please download our venue specific brochure



Heritage Zone



Olympic Stadium



01

Access
5 min. walk from JR Sobu Line : "Sendagaya" / "Shinanomachi" station
1 min. walk from Toei Oedo Line : "Kokuritsu Kyogijo" station

Tokyo Metropolitan Gymnasium



02

Access
1 min. walk from JR Sobu Line : "Sendagaya" station
Toei Oedo Line : "Kokuritsu Kyogijo" station

Yoyogi National Stadium



03

Access
5 min. walk from JR Yamanote Line : "Harajuku" station

Nippon Budokan

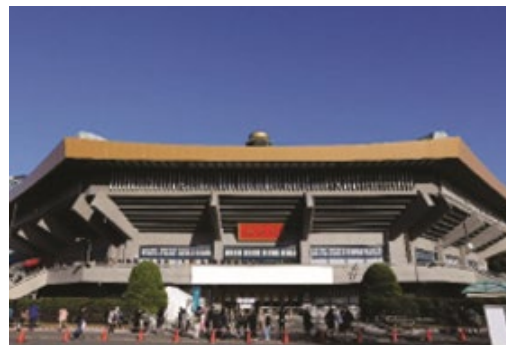

04

Access
5 min. walk from Tokyo Metro Tozai Line/ Hanzomon Line/ Toei Shinjuku Line : "Kudanshita" station



Heritage Zone

Imperial Palace Garden



Access
Will be posted later

Kokugikan Arena



Access
1 min. walk from JR Sobu Line : "Ryogoku" station West Exit
5 min. walk from Toei Oedo Line : "Ryogoku" station Exit A-3



05

Tokyo International Forum



Access
1 min. walk from, Tokyo Metro Yurakucho Line /
Keihin Tohoku Line / JR Yamanote Line: "Yurakucho" station

06

07

Equestrian Park



Access
15 min. walk from Tokyu Dennen-toshi Line :
"Sakura-shinmachi" station
3 min. walk from Tokyu Bus, Odakyu Bus : "Nodai-mae"

08



Musashino Forest Sport Plaza



Access
5 min. walk from
Keio Line : "Tobitakyu" station

09

Tokyo Stadium



Access
5 min. walk from
Keio Line : "Tobitakyu" station

10

Musashinomori Park



Access
Will be posted later

11



Tokyo Bay Zone



Ariake Arena



Access
8 min. walk from Yurikamome Line : "Ariake-Tennis-no-mori" station
Yurikamome Line : "Shin-toyosu" station

12

Ariake Gymnastics Centre



Access
Will be posted later

13

Ariake Urban Sports Park



Access
Will be posted later

14

Ariake Tennis Park



Access
5 min. walk from
Rinkai Line : "Kokusai-tenjijo" station

15



Odaiba Marine Park



Access
Will be posted later

16

Shiokaze Park



Access
5 min. walk from
Yurikamome Line : "Daiba" station

17

Aomi Urban Sports Park



Access
Will be posted later

18

Oi Hockey Stadium



Access
8 min. walk from
Tokyo Monorail : "Oi Keibajo Mae" station

19



Sea Forest Cross-Country Course



Access
Will be posted later

20

Sea Forest Waterway



Access
15 min. by taxi from JR Keiyo Line/ Tokyo Metro Yurakucho Line/ Rinkai Line : "Shin-kiba" station

21

Kasai Canoe Slalom Centre



Access
12 min. walk from
JR Keiyo Line : "Kasai Rinkai Koen" station

22

Yumenoshima Park Archery Field

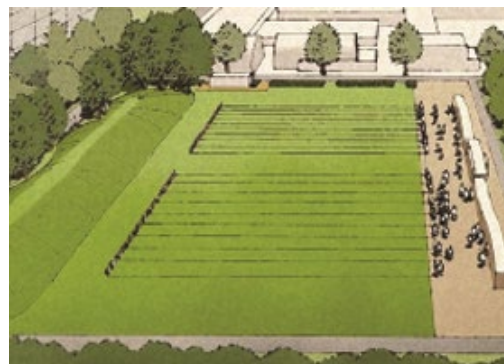

Access
7 min. walk from JR Keiyo Line/ Tokyo Metro Yurakucho Line/ Rinkai Line : "Shin-kiba" station

23



Tokyo Aquatics Centre

24

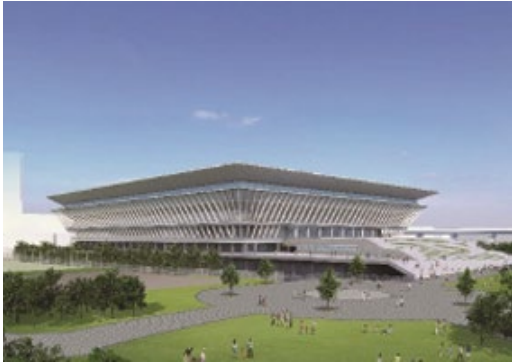

Access
10 min. walk from Tokyo Metro Yurakucho Line :
"Tatsumi" station

Tatsumi Water Polo Centre

25



Access
7 min. walk from
Tokyo Metro Yurakucho Line : "Tatsumi" station

Makuhari Messe

26 / 27 / 28



Access
5 min. walk from
JR Keiyo Line : "Kaihin Makuhari" station



Other Venues



Tsurigasaki Surfing Beach



Access
Will be posted later

Asaka Shooting Range



Access
Will be posted later



29

Saitama Super Arena



Access
3 min. walk from JR Keihin Tohoku Line/ Utsunomiya Line/ Takasaki Line : "Saitama Shin-toshin" station

31

Kasumigaseki Country Club



Access
15 min. walk from
JR Kawagoe Line : "Kasahata" station

30

32



Enoshima Yacht Harbour



Access

8 min. walk from Odakyu Line : "Katase Enoshima" station
21 min. walk from Enoden : "Enoshima" station

Izu MTB Course



Access

1 min. walk from
Shin Tokai Bus: "Cycle Sports Centre" stop

33

Izu Velodrome

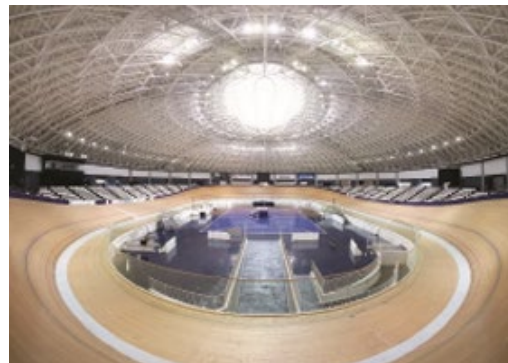

Access

1 min. walk from
Shin Tokai Bus: "Cycle Sports Centre" stop

35

Fuji International Speedway



Access

20 min. by taxi from
JR Gotemba Line : "Gotemba" station

34

36



Fukushima Azuma Baseball Stadium

37



Access

5 min. walk from JR Sobu Line : "Sendagaya" / "Shinanomachi" station
1 min. walk from Toei Oedo Line : "Kokuritsu Kyogijo" station

Yokohama Baseball Stadium

38



Access

2 min. walk from
JR Negishi Line : "Kannai" station South Exit

Sapporo Dome

39



Access

10 min. walk from
Toho Subway : "Fukuzumi" station



Miyagi Stadium

40



Access

10 min. by Miyagi Kotsu Bus from
JR Tohoku Honsen : "Rifu" station



Ibaraki Kashima Stadium

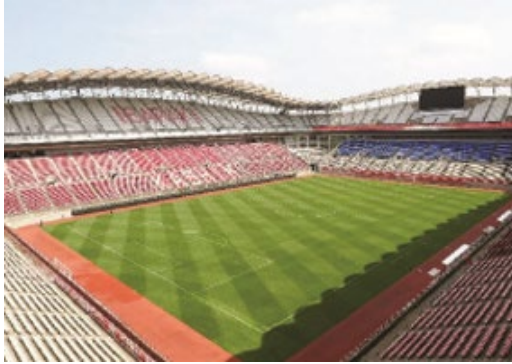

Access
2 min. walk from Kashima Rinkai Train :
"Kashima Soccer Stadium" station

41

Saitama Stadium



Access
15 min. walk from
Saitama Express Train "Urawa Misono"

42

International Stadium Yokohama

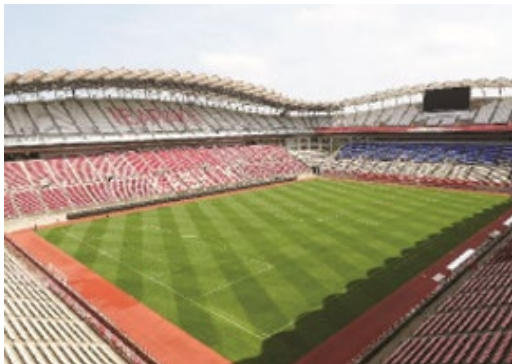

Access
14 min. walk from JR Tokaido Shinkansen/ JR Yokohama Line
Yokohama Subway

43

